

SF150WP Open Frame Series

3" x 3" ITE Open Frame



150 Watts

Highlights:

- ✓ 150W output power convection cooled
- ✓ 9 Vdc - 54 Vdc
- ✓ RoHS, REACH compliant
- ✓ PCB
- ✓ 3 Year Warranty
- ✓ Can be modified or customized for an exact fit solution



Output voltage and current

Output Voltage Range	Convection Output Current	Convection Output Power
9-54 Vdc	2.77-12.5 A	150 W Max

Electrical Characteristics

Input Voltage & Frequency:	80-264 (47 - 63 Hz)
Input Current:	2 A Max
Leakage Current:	Class I: 3.5mA Max. Class II: 0.25mA Max.
Ripple & Noise (Pk-Pk):	1% of O/P voltage
Operating Temperature:	-20°C to +40°C
Efficiency:	DoE Level 6 (VI) CoC v5 Tier 2
Withstanding Voltage:	Input to Output: 3000VAC
Mean Time Between Failure (MTBF):	100,000 Hrs Min. (Telcordia SR-332)
Protections:	Short Circuit Protection, Over-voltage Protection, Over-current Protection, Over-temperature Protection
Industry Compliance:	Directive (EU) 2015/863 (RoHS 3), REACH, DoE VI, EC:2019/1782, CoC v5 Tier 2
EMI/EMC Requirements:	FCC Part 15 Class B, EN 55032 Class B, AS/NZS CISPR-32 Class B, J55032(H29), ICES-003, EN 55035, EN/IEC 61000-3-2, -3-3

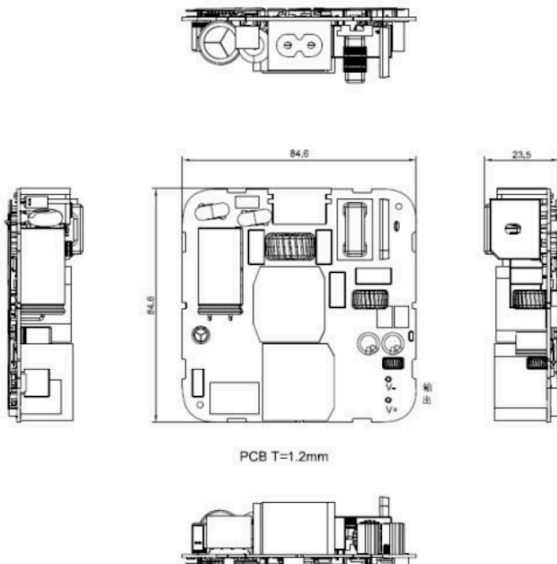

Not seeing what you are looking for? Contact us:

Tel. (516) 433-1313 · 264 Duffy Avenue, Hicksville, New York 11801 · www.apxonline.com · Email: sales@apxonline.com