

# SF120WP Open Frame Series

## 3" x 3" ITE Open Frame



120 Watts

### Highlights:

- ✓ 120W output power convection cooled
- ✓ 9 Vdc - 54 Vdc
- ✓ RoHS, REACH compliant
- ✓ PCB
- ✓ 3 Year Warranty
- ✓ Can be modified or customized for an exact fit solution



### Output voltage and current

Output Voltage Range	Convection Output Current	Convection Output Power
9-54 Vdc	2.22-10.0 A	120 W Max

### Electrical Characteristics

Input Voltage & Frequency:	80-264 (47 - 63 Hz)
Input Current:	1.5 A Max
Leakage Current:	Class I: 3.5mA Max.   Class II: 0.25mA Max.
Ripple & Noise (Pk-Pk):	1% of O/P voltage
Operating Temperature:	-20°C to +40°C
Efficiency:	DoE Level 6 (VI)   CoC v5 Tier 2
Withstanding Voltage:	Input to Output: 3000VAC
Mean Time Between Failure (MTBF):	100,000 Hrs Min. (Telcordia SR-332)
Protections:	Short Circuit Protection, Over-voltage Protection, Over-current Protection, Over-temperature Protection
Industry Compliance:	Directive (EU) 2015/863 (RoHS 3), REACH, DoE VI, EC:2019/1782, CoC v5 Tier 2
EMI/EMC Requirements:	FCC Part 15 Class B, EN 55032 Class B, AS/NZS CISPR-32 Class B, J55032(H29), ICES-003, EN 55035, EN/IEC 61000-3-2, -3-3

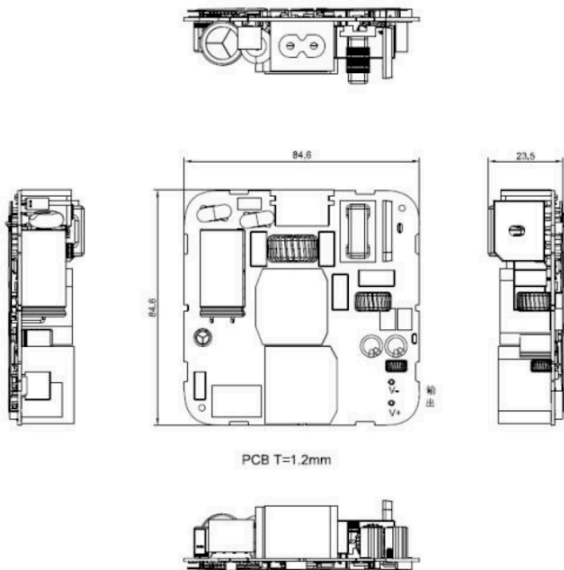

Not seeing what you are looking for? Contact us:

Tel. (516) 433-1313 · 264 Duffy Avenue, Hicksville, New York 11801 · [www.apxonline.com](http://www.apxonline.com) · Email: [sales@apxonline.com](mailto:sales@apxonline.com)