

IB100WP5PD GaN Wall Mount Series

GaN USB-PD Interchangeable Wall Mount



100W 1× USB-C + 1× USB-A

Highlights:

- ✓ 100W 1× USB-C + 1× USB-A
- ✓ USB Power Delivery | Gallium Nitride (GaN) Design
- ✓ USB-C: 5V, 9V, 12V, 15V, 20V | USB-A: 5V, 9V, 12V
- ✓ US, EU, AUS, UK AC input options
- ✓ RoHS, REACH, DoE VI, CoC v5 Tier 2 compliant
- ✓ Certified: ETL|CE|RCM|PSE
- ✓ 3 Year Warranty
- ✓ Can be modified or customized for an exact fit solution



Output voltage and current

Port Type	Output Voltage and Current:	Output Power:
USB-C (1)	5V @ 3A, 9V @ 3A, 12V @ 3A, 15V @ 3A, 20V @ 5A	100W
USB-A (1)	5V @ 3A, 9V @ 3A, 12V @ 2.5A	30W

Electrical Characteristics

Charging Protocols:	USB-C: PPS/PD2.0/PD2.0/QC4+/QC4/QC3.0/QC2.0/AFC/FCP/SCP/PE2.0/PE1.1/SFCP/ USB-A: QC3.0/QC2.0/AFC/FCP/SCP/PE2.0/PE1.1/SFCP
Input Voltage & Frequency:	90 - 264 (47 - 63 Hz)
Input Current:	2 A Max
Leakage Current:	Class I: 3.5mA Max. Class II: 0.25mA Max.
Ripple & Noise (Pk-Pk):	1% of O/P voltage
Operating Temperature:	-20°C to +40°C
Efficiency:	DoE Level VI and CoC v5 Tier 2 Criteria
Withstanding Voltage:	Input to Output: 3000 VAC
Mean Time Between Failure (MTBF):	100,000 Hrs Min. (Telcordia SR-332)
Protections:	Short Circuit Protection, Over-voltage Protection, Over-current Protection, Over-temperature Protection
Industry Compliance:	Directive (EU) 2015/863 (RoHS 3), REACH, DoE VI, EC:2019/1782, CoC v5 Tier 2
EMI/EMC Requirements:	FCC Part 15 Class B, EN 55032 Class B, AS/NZS CISPR-32 Class B, J55032(H29), ICES-003, EN 55035, EN/IEC 61000-3-2, -3-3
Safety Compliance:	ETL:62368-1, EN:62368(Ed.2), AS/NZS:62368.1:2018, J:62368(Ed.3)

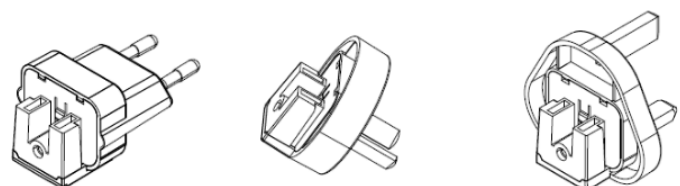
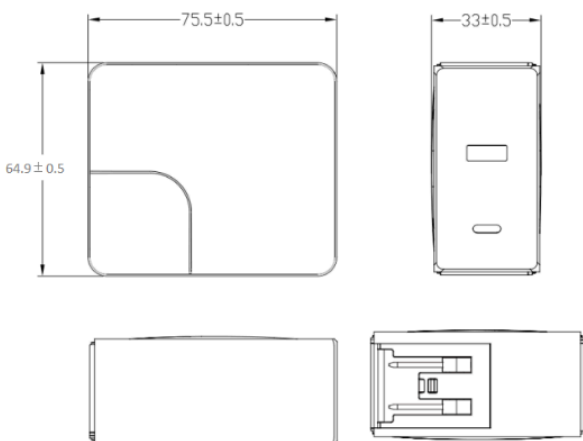

Not seeing what you are looking for? Contact us:

Tel. (516) 433-1313 · 264 Duffy Avenue, Hicksville, New York 11801 · www.apxonline.com · Email: sales@apxonline.com