



SMF144Q – SMF150Q Series

144 – 150 Watt AC-DC Open Frame Medical Power Supply
IEC 60101-1-2 4th Ed. EMC, Energy Efficiency Level VI

Date: 10/2/17

Rev: 033117

Page: 1 of 1



The SMF144Q – SMF150Q Series switch mode power supply offers 144 Watts to 150 Watts output power, with an output voltage range of 12 Vdc, 24 Vdc, and 48 Vdc. Case style is an open frame with pin header, with ES/EN/IEC 60601-1 3.1 Edition safety approvals, IEC 60601-1-2 4th Edition EMC, UL/EN 60950-1 2nd Edition Safety approval, and Energy Efficiency Level 6.



Features:

- Universal Input 100 - 240 Vac
- Over-Voltage, Over-Current, Over-Temperature, and Short Circuit Protection
- 2 x MOPP Protection
- < 100 μ A Touch Current
- 100% Burn-In
- RoHS 2 Compliant
- Energy Efficiency Level: VI
- Meets IEC 60950-1 2nd Edition
- Meets IEC 60601-1-2: 2014 4th Edition EMC

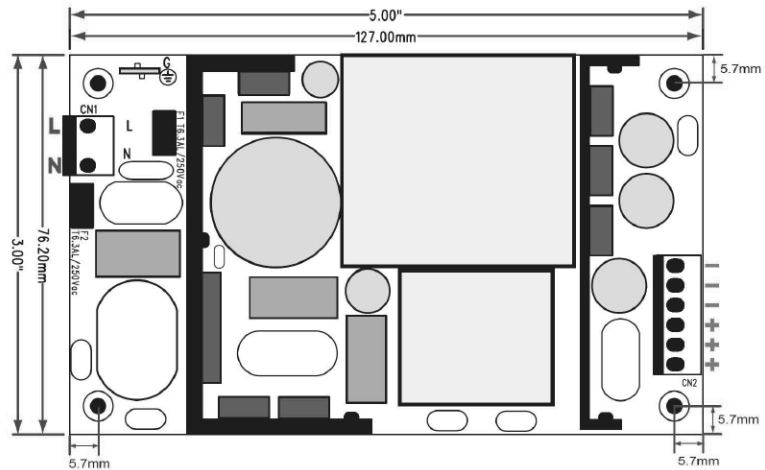

SMF Q1 AR

Output Voltage: See Table

Output Power: See Table

Electrical Information

Input Voltage	90 to 264 Vac
Input Frequency	47 to 63 Hz
Input Current	0.8 – 2.0 A
Over-Voltage Protection	Unit is protected from over-voltage conditions
Over-Current Protection	Unit is protected from over-current conditions
Over-Temperature Protection	Unit is protected from over-temperature conditions
Hold-Up Time	10 ms
Operating Temperature	0 - 50°C
Storage Temperature	-20 - 80°C
Weight	320 g (Ref.)
Industry Compliance	RoHS 2, Energy Efficiency Level VI
EMC Requirements	IEC 60601-1-2: 2014 4 th Edition
EMI Requirements	Meets Conduction and Radiation Limits of: Class B: FCC Part 18, CISPR-11, EN 55011

Output Voltage	Output Current	Output Power (Max.)
12 Vdc	12.00 A	144 W
24 Vdc	6.25 A	150 W
48 Vdc	3.12 A	150 W

Safety Compliance

UL/c-UL (UL 60950-1: 2nd Edition), CB (I.T.E.), FCC,
UR/c-UR (ES 60601-1: 3.1 Edition),
TUV T- Mark (EN/IEC 60601-1: 3.1 Edition)